

Flat fan nozzle with double-flat alignment

Series 6M2

Series 6M2

Assembly with retaining nut.
Self aligning jet with double-flat design secures correct spray position for optimal strand surface quality and easy maintenance. Standard version with parabolic liquid distribution.

Applications:

Multi nozzle arrangements for strand cooling in foot roller area of slab casters where space is limited.
Multi nozzle arrangements in segments for water only secondary cooling in stainless steel slab casters with low water flow rates.

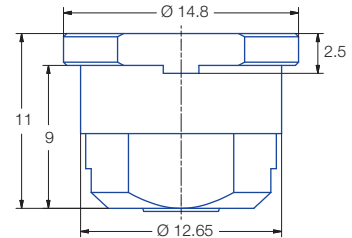
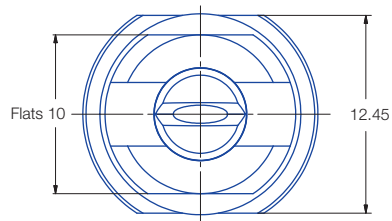
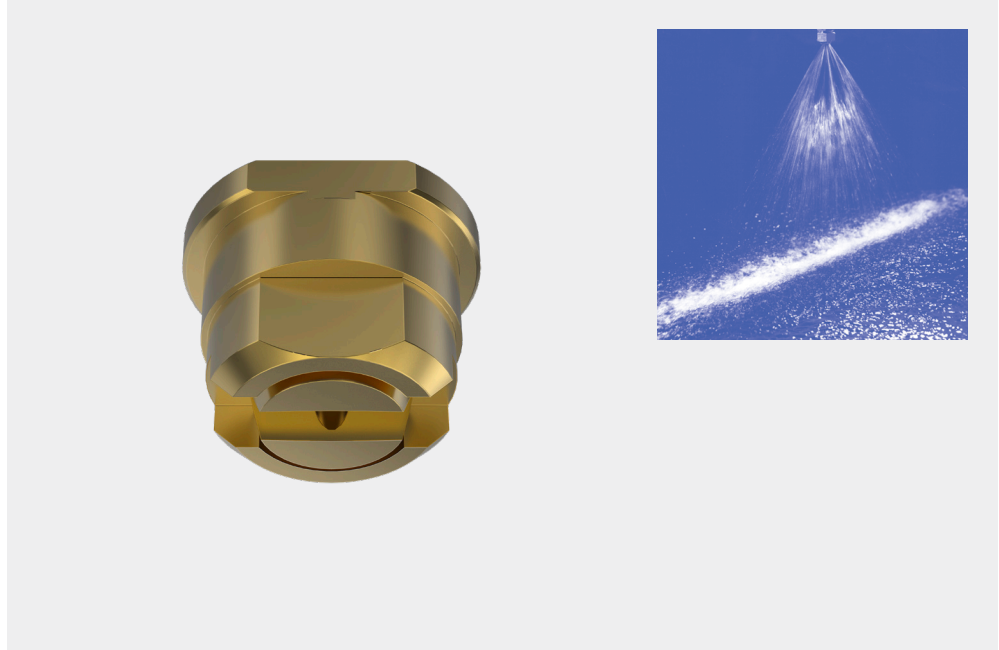

Accessories

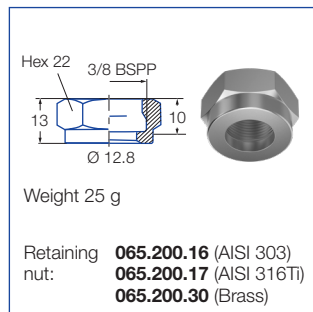
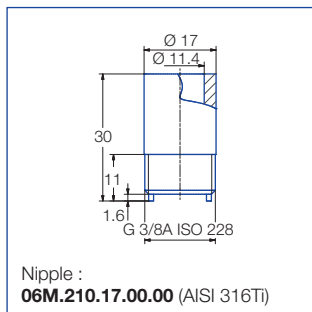

Spray angle 	Ordering no.				A Ø [mm]	E Ø [mm]	V̇ [l/min]						
	Type	Mat. no.					p [bar]						
		16 303 SS	17 ¹ 316Ti SS/ 316L SS	30			0.5	1.0	2.0	[US gal./ min] at 40 psi	3.0	5.0	10.0
45°	6M2.403	○	○	○	1.20	0.90	0.50*	0.71	1.00	0.31	1.23	1.58	2.24
	6M2.483	○	○	○	1.50	1.10	0.80*	1.13	1.60	0.50	1.96	2.53	3.58
	6M2.563	○	○	○	2.00	1.40	1.25	1.77	2.50	0.78	3.06	3.95	5.59
	6M2.643	○	○	○	2.50	1.80	2.00	2.83	4.00	1.24	4.90	6.33	8.94
	6M2.723	○	○	○	3.00	2.40	3.15	4.46	6.30	1.95	7.72	9.96	14.09
	6M2.763	○	○	○	3.50	2.60	4.00	5.66	8.00	2.48	9.80	12.65	17.89
	6M2.803	○	○	○	4.00	3.00	5.00	7.07	10.00	3.10	12.25	15.81	22.36
60°	6M2.404	○	○	○	1.20	0.80	0.50*	0.71	1.00	0.31	1.23	1.58	2.24
	6M2.444	○	○	○	1.35	0.90	0.62*	0.88	1.25	0.39	1.53	1.98	2.80
	6M2.484	○	○	○	1.50	1.00	0.80*	1.13	1.60	0.50	1.96	2.53	3.58
	6M2.514	○	○	○	1.65	1.10	0.95*	1.34	1.90	0.59	2.33	3.00	4.25
	6M2.564	○	○	○	2.00	1.30	1.25	1.77	2.50	0.78	3.06	3.95	5.59
	6M2.604	○	○	○	2.20	1.50	1.58	2.23	3.15	0.98	3.86	4.98	7.04
	6M2.644	○	○	○	2.50	1.60	2.00	2.83	4.00	1.24	4.90	6.33	8.94
	6M2.674	○	○	○	2.70	1.80	2.38	3.36	4.75	1.47	5.82	7.51	10.62
	6M2.724	○	○	○	3.00	2.10	3.15	4.46	6.30	1.95	7.72	9.96	14.09
	6M2.764	○	○	○	3.50	2.30	4.00	5.66	8.00	2.48	9.80	12.65	17.89
	6M2.804	○	○	○	4.00	2.60	5.00	7.07	10.00	3.10	12.25	15.81	22.36
	6M2.844	○	-	-	4.50	3.00	6.25	8.84	12.50	3.88	15.31	19.76	27.95
	6M2.884	○	-	○	5.00	3.40	8.00	11.31	16.00	4.96	19.60	25.30	35.78
90°	6M2.446	○	○	○	1.35	0.80	0.62*	0.88	1.25	0.39	1.53	1.98	2.80
	6M2.486	○	○	○	1.50	0.80	0.80*	1.13	1.60	0.50	1.96	2.53	3.58
	6M2.516	○	○	○	1.65	0.90	0.95*	1.34	1.90	0.59	2.33	3.00	4.25
	6M2.566	○	○	○	2.00	1.10	1.25	1.77	2.50	0.78	3.06	3.95	5.59
	6M2.606	○	○	○	2.20	1.20	1.58	2.23	3.15	0.98	3.86	4.98	7.04
	6M2.646	○	○	○	2.50	1.30	2.00	2.83	4.00	1.24	4.90	6.33	8.94
	6M2.676	○	○	○	2.70	1.40	2.38	3.36	4.75	1.47	5.82	7.51	10.62
	6M2.726	○	○	○	3.00	1.70	3.15	4.46	6.30	1.95	7.72	9.96	14.09
	6M2.766	○	○	○	3.50	1.90	4.00	5.66	8.00	2.48	9.80	12.65	17.89
	6M2.806	○	○	○	4.00	2.40	5.00	7.07	10.00	3.10	12.25	15.81	22.36
	6M2.846	-	-	○	4.50	2.40	6.25	8.84	12.50	3.88	15.31	19.76	27.95
		6M2.886	○	-	○	5.00	3.10	8.00	11.31	16.00	4.96	19.60	25.30
120°	6M2.517	○	○	○	1.65	0.90	0.95*	1.34	1.90	0.59	2.33	3.00	4.25
	6M2.567	○	○	○	2.00	0.90	1.25	1.77	2.50	0.78	3.06	3.95	5.59
	6M2.607	○	○	○	2.20	1.10	1.58	2.23	3.15	0.98	3.86	4.98	7.04
	6M2.647	○	○	○	2.50	1.30	2.00	2.83	4.00	1.24	4.90	6.33	8.94
	6M2.677	○	○	○	2.70	1.40	2.38	3.36	4.75	1.47	5.82	7.51	10.62
	6M2.727	○	○	○	3.00	1.60	3.15	4.46	6.30	1.95	7.72	9.96	14.09
	6M2.767	○	○	○	3.50	1.70	4.00	5.66	8.00	2.48	9.80	12.65	17.89
	6M2.807	○	-	○	4.00	2.00	5.00	7.07	10.00	3.10	12.25	15.81	22.36
	6M2.847	-	-	-	4.50	2.30	6.25	8.84	12.50	3.88	15.31	19.76	27.95
		6M2.887	-	-	-	5.00	2.60	8.00	11.31	16.00	4.96	19.60	25.30

¹We reserve the right to deliver 316Ti SS oder 316L SS under the material no. 17.

A = equivalent bore diameter · E = narrowest free cross section

* differing spray pattern

Subject to technical modifications.

Example	Type	+	Material no.	=	Ordering no.
of ordering:	6M2.404	+	16	=	6M2.404.16

Conversion formula for the above series: $\dot{V}_2 = \dot{V}_1 \cdot \sqrt{\frac{p_2}{p_1}}$

