

Rotating cleaning nozzle XactClean HP 2 Series 5S6/5S7



Features:

- Flat fan nozzle with high impact
- Uniform cleaning
- High efficiency due to controlled rotation
- High operating reliability thanks to robust drive unit



**ATEX version
on request**

Series 5S6/5S7

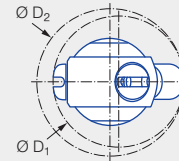

Insertion diameter D_1
and interference circle diameter D_2
of the threaded connection

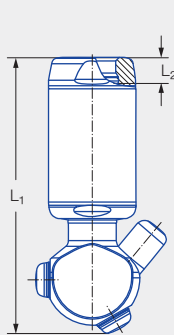

Female thread

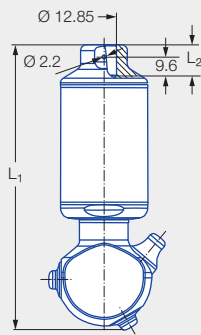

Dimensions of
1/2" slip-on connection
according to
ASME-BPE (OD tube)

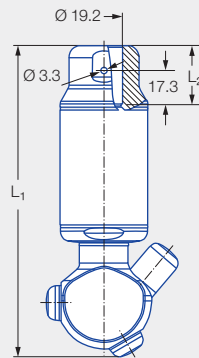

Dimensions of
3/4" slip-on connection
according to
ASME-BPE (OD tube)

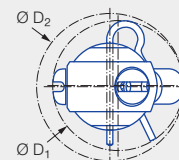

Insertion diameter D_1
and interference circle diameter D_2
of the slip-on connection

EPDM O-rings	FKM O-rings	Connection	Dimensions [mm]			
			L_1	L_2	Insertion diameter D_1	Interference circle diameter D_2
AF	20	3/8 BSPP	141.0	9.0	50.0–66.0	50.0–67.0
AH	21	1/2 BSPP	143.0	13.0	50.0–74.0	50.0–76.0
AL	22	3/4 BSPP	143.0	13.2	50.0–79.0	50.0–81.0
AN	23	1 BSPP	140.0	16.5	51.0–79.0	53.0–80.0
TF05	30	1/2" slip-on connection	150.0	16.0	52.0–66.0	50.0–67.0
TF07	31	3/4" slip-on connection	160.0	30.0	66.0–79.0	50.0–81.0

Max. tank diameter [m]	0	1	2	3	4	5	6	7	8	9
-------------------------------	---	---	---	---	---	---	---	---	---	---

Cleaning efficiency class
4

Max. temperature
150 °C

Installation
Operation in every direction is possible

Bearing
Double ball bearing

Material
Stainless steel 316L, EPDM or FKM

Recommended operating pressure
3 bar





Filtration
Line strainer with a mesh size of 0.3 mm/50 mesh

Rotation monitoring
Sensor compatible, for information: See Page 229

Adapter
3/8 BSPP, 1/2 BSPP, 3/4 BSPP and 1 BSPP are compatible with HygienicFit

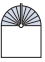
Function video
www.lechler.com/de-en/medialibrary/videos-general-industry
Or scan the QR code.



Spray angle	Ordering no.														Narrowest cross-section Ø [mm]	V̇ water [l/min]					Max. tank diameter [m]		
	Type	Connection												p [bar] (p _{max} = 15 bar)									
		3/8 BSPP		1/2 BSPP		3/4 BSPP		1 BSPP		1/2" slip-on connection		3/4" slip-on connection		2.0		3.0	5.0	10.0	at 40 psi [US gal/min]				
		EPDM	FKM	EPDM	FKM	EPDM	FKM	EPDM	FKM	EPDM	FKM	EPDM	FKM										
180° 	5S6.963.1Y	AF	20	AH	21								TF05	30			1.7	25	31	40	57	8	3.5
	5S7.043.1Y			AH	21										TF07	31	2.0	41	50	65	92	13	4.0
	5S7.113.1Y			AH	21	AL	22								TF07	31	2.0	60	73	94	133	18	6.0
	5S7.183.1Y					AL	22								TF07	31	2.0	89	109	141	199	28	7.0
	5S7.223.1Y					AL	22								TF07	31	2.0	111	136	175	248	34	7.5
	5S7.253.1Y					AL	22	AN	23						TF07	31	2.0	135	165	213	301	42	8.0
180° 	5S6.964.1Y	AF	20	AH	21								TF05	30			1.7	25	31	40	57	8	3.5
	5S7.044.1Y			AH	21										TF07	31	2.0	41	50	65	92	13	4.0
	5S7.114.1Y			AH	21	AL	22								TF07	31	2.0	60	73	94	133	18	6.0
	5S7.184.1Y					AL	22								TF07	31	2.0	89	109	141	199	28	7.0
	5S7.224.1Y					AL	22								TF07	31	2.0	111	136	175	248	34	7.5
	5S7.254.1Y					AL	22	AN	23						TF07	31	2.0	135	165	213	301	42	8.0
270° 	5S6.965.1Y	AF	20	AH	21								TF05	30			1.7	25	31	40	57	8	3.5
	5S7.045.1Y			AH	21										TF07	31	2.0	41	50	65	92	13	4.0
	5S7.115.1Y			AH	21	AL	22								TF07	31	2.0	60	73	94	133	18	6.0
	5S7.185.1Y					AL	22								TF07	31	2.0	89	109	141	199	28	7.0
	5S7.225.1Y					AL	22								TF07	31	2.0	111	136	175	248	34	7.5
	5S7.255.1Y					AL	22	AN	23						TF07	31	2.0	135	165	213	301	42	8.0
270° 	5S6.966.1Y	AF	20	AH	21								TF05	30			1.7	25	31	40	57	8	3.5
	5S7.046.1Y			AH	21										TF07	31	2.0	41	50	65	92	13	4.0
	5S7.116.1Y			AH	21	AL	22								TF07	31	2.0	60	73	94	133	18	6.0
	5S7.186.1Y					AL	22								TF07	31	2.0	89	109	141	199	28	7.0
	5S7.226.1Y					AL	22								TF07	31	2.0	111	136	175	248	34	7.5
	5S7.256.1Y					AL	22	AN	23						TF07	31	2.0	135	165	213	301	42	8.0
360° 	5S6.969.1Y	AF	20	AH	21								TF05	30			1.5	25	31	40	57	8	3.5
	5S7.049.1Y			AH	21										TF07	31	2.0	41	50	65	92	13	4.0
	5S7.119.1Y			AH	21	AL	22								TF07	31	2.0	60	73	94	133	18	6.0
	5S7.189.1Y					AL	22								TF07	31	2.0	89	109	141	199	28	7.0
	5S7.229.1Y					AL	22								TF07	31	2.0	111	136	175	248	34	7.5
	5S7.259.1Y					AL	22	AN	23						TF07	31	2.0	135	165	213	301	42	8.0

NPT thread available on request.

The maximum tank diameter applies to the recommended operating pressure and is meant as a recommendation only.
The cleaning result is also affected by the type of soiling.

Compressed air should be used for dry blowing for a short time only. Operation above the recommended operating pressure has a negative impact on the cleaning result and wear.

Information about slip-on connections

- Pin made of stainless steel 316L included (ordering no. 095.022.1Y.50.60.E (TF07), 095.013.1E.05.59 (TF05)).
- Depending on the diameter of the adapter, the flow rate can increase due to a leakage between the adapter and the rotating cleaning nozzle.

Ordering Type + Code = Ordering no.
example: 5S6.963.1Y + AF = 5S6.963.1Y.AF